

Travelling To & From School

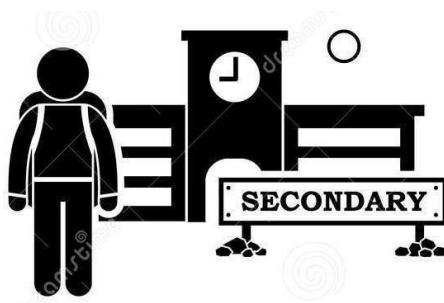

Operating Hours of School Gates

Access to school site

Vehicle access is allowed into the school in the mornings and on rainy days at stipulated times:

0615 – 0740	School assembly (Monday to Friday)
1400 – 1500	School dismissal (Monday to Thursday) (on rainy days only)
1230 – 1300	School dismissal (Friday) (on rainy days only)

Staff vehicles enter the school and exit from the school via the main gate. The designated car park is located in front of the foyer and along the service road at the rear of the school.

Authorised pedestrians (including staff, students and parents) may enter and exit from the school via the following gates and time:

- Front Side Gate: 0615 – 0740
- Rear Gate: 0630 – 0740, after school dismissal – 1900 (exit only)

Cycling in School and on Public Roads

Given the hazards that cyclists may encounter, the school is concerned about the safety of students who cycle to school and does not encourage cycling to school.

Students who wish to cycle to school will need to register their intent with Mr Zaini Zainol, Operations Manager, for record and monitoring purposes. These students will then receive an advisory note to be given to parents for acknowledgement. It is only after the school receives the acknowledgement by parents that students will be allowed to cycle to school.

Further details can be found in the Student Handbook.

Note:

All students entering Secondary One in Jan 2026 will be issued with a new Secondary level School Smart Cards (SSC).

While Secondary One students are waiting for their Secondary level SSCs to be ready, they can continue to use their Primary level SSCs for concessionary travel till end Apr 2026. Students can still purchase the Bus Concession Pass (BCP) using their Primary level SSCs but they would need to purchase the BCP for Secondary School students.

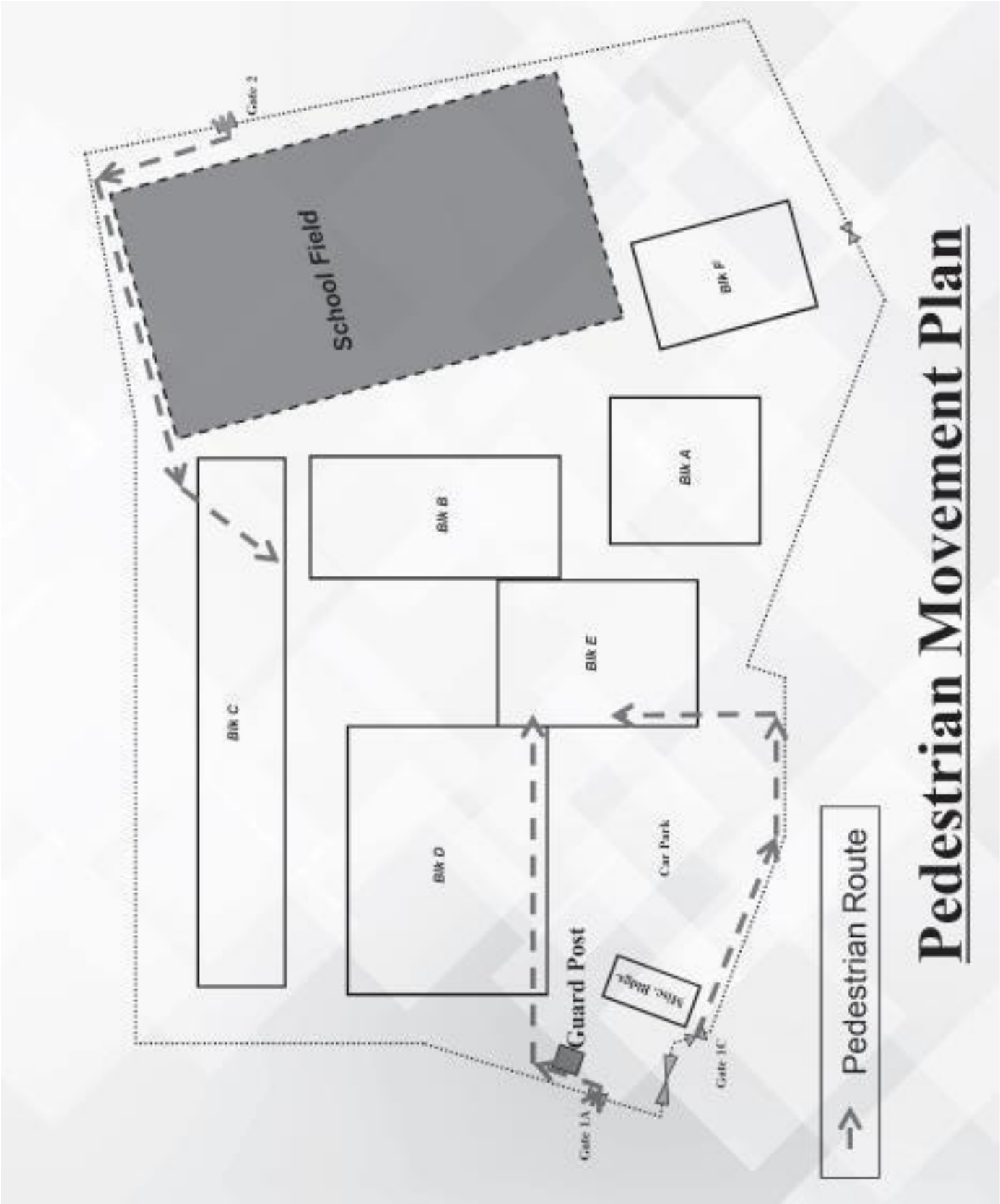

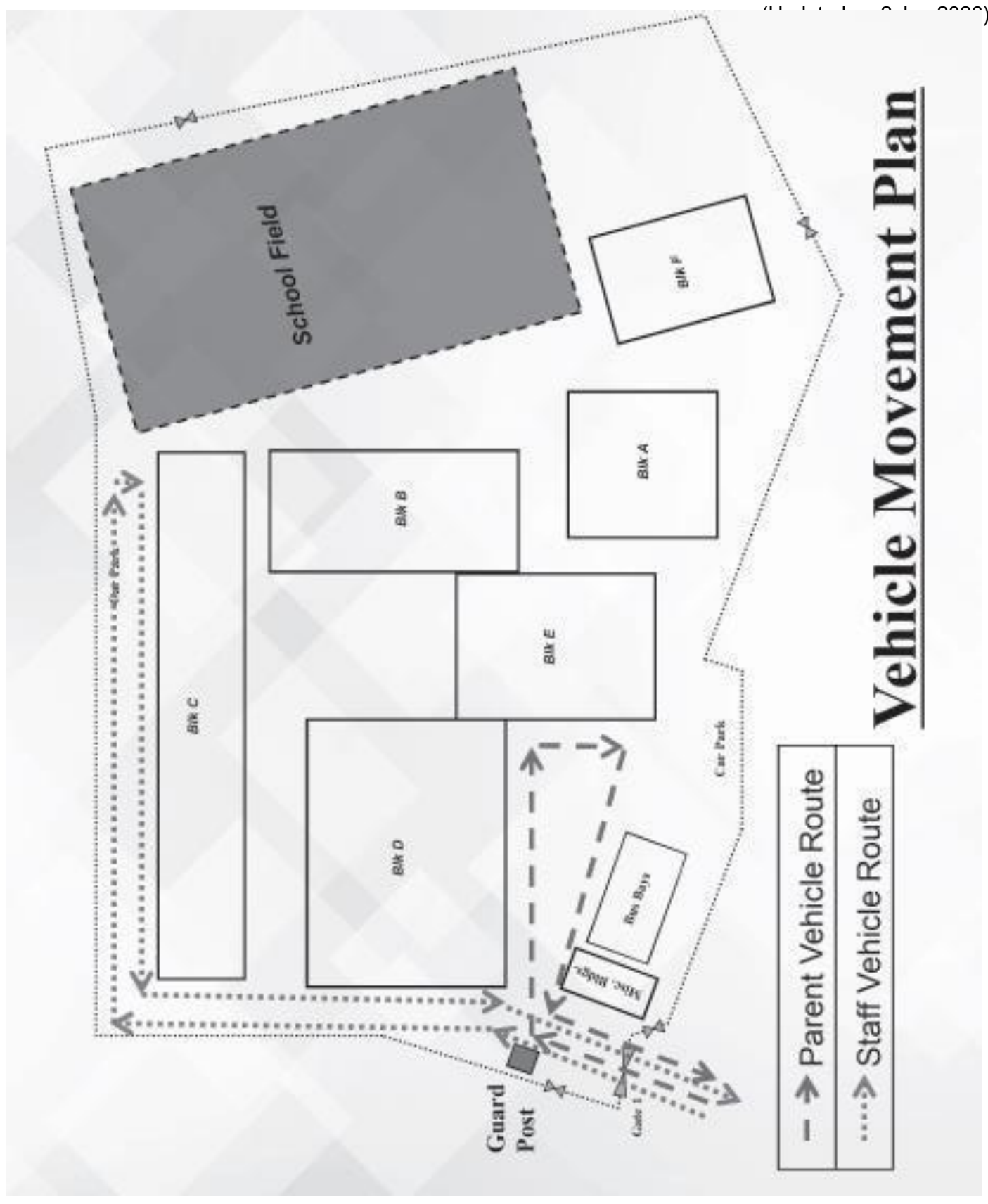

Vehicle Movement Plan